

PROJECT:
MPS DAYCARE
 201 N. EASTERN
 MOORE OK
 PROJECT NUMBER: 24110
 DRAWING DATE: 11.05.24
 ISSUE DATE: 11.05.24

LEGEND

---	EXISTING 1" CONTOUR	---	EXISTING 5" CONTOUR
---	PROPOSED 1" CONTOUR	---	PROPOSED 5" CONTOUR
---	BOUNDARY LINE	---	RIGHT OF WAY LINE
---	EASEMENT LINE	---	EXISTING CURB AND GUTTER
---	PROPOSED CURB AND GUTTER	---	PROPOSED FIRE LANE STRIPING
---	OHE	---	OVERHEAD ELECTRIC LINE
---	UGE	---	UNDERGROUND ELECTRIC LINE
---	GAS	---	GAS LINE
---	UGT	---	UNDERGROUND TELEPHONE LINE
---	FO	---	UNDERGROUND FIBER OPTIC LINE
---	SS	---	SANITARY SEWER LINE
---	W	---	WATERLINE
---	RETAINING WALL	---	SCREEN WALL
---	WIRE FENCE	---	CHAIN LINK FENCE
---	BENCHMARK	---	
+	PROP. FIRE HYDRANT	---	PROP. WHEEL STOP
+	PROP. WATER VALVE	---	PROP. FES
+	PROP. WATER METER	---	PROP. HC RAMP
+	PROP. ELECT. METER	---	PROP. POWER POLE
+	PROP. LIGHT POLE	---	PROP. SS MANHOLE
+	PROP. BOLLARD	---	PROP. GAS METER
+	PROP. TRANSFORMER	---	PROP. SIGN
+	PROP. PARKING COUNT	+	PROP. FIRE ROUTE SIGN
+	PROP. INLETS (SEE GRADING PLAN FOR TYPE)		
+	VERTICAL SEPARATION REQUIREMENT		

*NOTE: REFER TO SURVEYING LEGEND FOR EXISTING STRUCTURES IDENTIFICATION

UTILITY NOTES

- A. CONTRACTOR SHALL REFER TO THE CONSTRUCTION DOCUMENTS INCLUDING BUT NOT LIMITED TO THE WRITTEN SPECIFICATIONS, CONSTRUCTION DRAWINGS, STORM WATER POLLUTION PLAN, AND GEOTECHNICAL REPORT.
- B. ALL CONSTRUCTION SHALL BE IN STRICT ACCORDANCE WITH THE OWNERS DESIGN GUIDELINES AND SPECIFICATIONS, AND WHERE APPLICABLE SHALL MEET THE REQUIREMENTS OF THE GOVERNING/PERMITTING AUTHORITY HAVING JURISDICTION.
- C. CONTRACTOR IS RESPONSIBLE FOR THEIR OWN HORIZONTAL AND VERTICAL CONTROL, REFERENCE POINTS AND CONSTRUCTION STAKING AS INCIDENTAL TO THE PROJECT.
- D. THE CONTRACTOR SHALL FIELD VERIFY EXISTING ELEVATIONS/PROPERTY LINES/UTILITIES/DRAINAGE PRIOR TO CONSTRUCTION START.
- E. ALL WORK NOT CLASSIFIED AS A CONTRACT PAY ITEM SHALL BE CONSIDERED AS INCIDENTAL AND THE COST THEREOF SHALL BE INCLUDED IN THE UNIT PRICE BID FOR ITEMS WHICH ARE CLASSIFIED FOR PAYMENT.
- F. CONTRACTOR SHALL REFER TO THE ARCHITECTURAL AND MEP PLANS AND SPECIFICATIONS BEING A PART OF THE CONSTRUCTION DOCUMENTS FOR THE EXACT LOCATIONS AND DIMENSIONS OF ENTRY, EXIT PORCHES, PRECISE BUILDING DIMENSIONS, EXACT BUILDING UTILITY ENTRANCE, AND DOWNSPOUT LOCATIONS/SPECIFICATIONS/DETAILS.
- G. REFER TO ARCHITECTURE PLANS FOR SITE LIGHTING/LIGHT POLE BASES AND ELECTRICAL CONDUIT PLACEMENT AND SPECIFICATIONS. POLE LOCATIONS ARE SHOWN ON THIS SHEET FOR REFERENCE ONLY. IT IS THE CONTRACTOR'S RESPONSIBILITY TO IDENTIFY AND ADJUST ANY CONSTRUCTED CONFLICTS WITH UNDERGROUND UTILITIES, SIDEWALKS, ETC.
- H. CONTRACTOR IS REQUIRED TO CALL ONE CALL AS WELL AS THE APPROPRIATE UTILITY COMPANY AT LEAST 48 HOURS BEFORE ANY EXCAVATION/CONSTRUCTION ACTIVITIES TAKE PLACE. IT SHALL BE THE RESPONSIBILITY OF THE CONTRACTOR TO RELOCATE ALL EXISTING UTILITIES WHICH ARE IN CONFLICT WITH PROPOSED IMPROVEMENTS.
- I. CONTRACTOR SHALL ENSURE ALL CONSTRUCTED UTILITIES MEET THE MINIMUM SEPARATION AND COVER REQUIREMENTS SET FORTH BY THE PROVIDER, FEDERAL/STATE/LOCAL REGULATIONS, OR SPECIFICATIONS. IN THE EVENT THERE IS A CONFLICT THE MOST STRINGENT SHALL APPLY.
- J. GENERAL CONTRACTOR TO PROVIDE 2'X2'X6" THICK CONCRETE APRON AT ALL CLEANOUTS, VALVES AND METERS OUTSIDE OF BUILDING.
- K. GENERAL CONTRACTOR SHALL BE RESPONSIBLE FOR ALL TAP AND TIE ON FEES REQUIRED, AS WELL AS COST OF UNDERGROUND SERVICE CONNECTIONS TO THE BUILDINGS.
- L. THRUST BLOCKING SHALL BE PROVIDED AT ALL BENDS, TEES, AND FIRE HYDRANTS.
- M. DIMENSIONS SHOWN ARE TO CENTERLINE OF PIPE OR FITTING.
- N. ALL WATER AND SANITARY SEWER LEADS TO BUILDING SHALL END 5' OUTSIDE THE BUILDING LIMITS AS SHOWN ON PLAN AND SHALL BE PROVIDED WITH A TEMPORARY PLUG AT END.
- O. ALL FIRE HYDRANTS SHALL BE PROVIDED WITH AN APPROVED GATE VALVE A MAXIMUM OF 5'(UNLESS OTHERWISE SPECIFIED BY CITY OFFICIAL) FROM HYDRANT.
- P. CONTRACTOR SHALL COMPLY COMPLETELY WITH THE LATEST STANDARDS OF OSHA DIRECTIVES OR ANY OTHER AGENCY HAVING JURISDICTION FOR EXCAVATION AND TRENCHING PROCEDURES. THE CONTRACTOR SHALL USE SUPPORT SYSTEMS, SLOPING, BENCHING AND OTHER MEANS OF PROTECTION. THIS IS TO INCLUDE, BUT NOT LIMITED FOR ACCESS AND EGRESS FROM ALL EXCAVATION AND TRENCHING. CONTRACTOR IS RESPONSIBLE FOR COMPLYING WITH PERFORMANCE CRITERIA AS REQUIRED BY OSHA.
- Q. REFER TO FIRE PROTECTION SHEETS FOR LOCATION AND DETAIL OF FIRE LINE LEAD IN. FIRE LINE SHALL BE STUBBED UP 1' ABOVE FFE IN SPRINKLER ROOM.
- R. REFER TO PLUMBING SHEETS FOR LOCATION AND DETAILS OF SEWER, DOMESTIC, AND IRRIGATION CONNECTIONS.
- S. CONTRACTOR SHALL REFER TO IRRIGATION PLANS FOR ACTUAL LOCATION, SIZE, LENGTH AND DEPTH. TEMPORARILY PLUG BOTH ENDS. IRRIGATION CONTRACTOR WILL REMOVE TEMPORARY PLUGS, INSTALL LINES AND PROPERLY SEAL BOTH ENDS.
- T. THE FIRE DEPARTMENT CONNECTION (FDC) SHALL BE LOCATED ON THE STREET SIDE OF ANY STRUCTURE. THE FDC SHALL BE LOCATED AND ARRANGED SO THAT THE HOSE LINES CAN BE READILY ATTACHED TO THE INLETS WITHOUT INTERFERENCE FROM OBJECTS.
- U. IT IS THE CONTRACTOR'S RESPONSIBILITY TO COORDINATE THE EXTENSIONS OF ALL UTILITY SERVICE LINES TO THE MAIN UTILITY LINES.
- V. ALL CONDUIT SHALL BE SCHEDULE 40 PVC, UNLESS OTHERWISE NOTED.
- W. CONTRACTOR SHALL REFER TO LANDSCAPE AND IRRIGATION PLAN FOR LOCATION AND CONSTRUCTION DETAILS OF LANDSCAPING AND IRRIGATION.

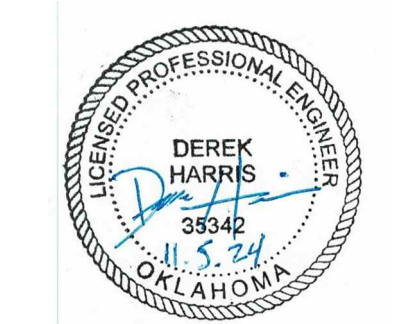
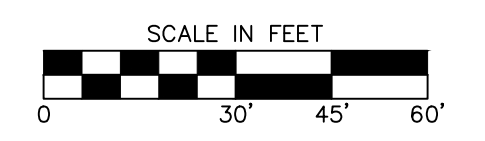

SUBMITTAL:
PERMIT SET

REVISIONS:

MARK	DATE	DESCRIPTION

THESE PLANS AND DRAWINGS ARE NOT TO BE REPRODUCED, CHANGED OR COPIED IN ANY FORM OR MANNER WHATSOEVER WITHOUT FIRST OBTAINING THE WRITTEN PERMISSION AND CONSENT OF CEDAR CREEK CONSULTING INC. THIS SHEET IS NOT TO BE USED FOR CONSTRUCTION UNLESS THE ISSUE DATE IN THE TITLE BLOCK COINCIDES WITH OR POST DATES THE DRAWING DATE. ANY CHANGES MADE FROM THESE PLANS WITHOUT CONSENT OF CEDAR CREEK CONSULTING INC. ARE UNAUTHORIZED AND SHALL RELIEVE CEDAR CREEK CONSULTING OF RESPONSIBILITY FOR ALL CONSEQUENCES ARISING OUT OF SUCH CHANGES.

DRAWING TITLE:
UTILITY PLAN
 SHEET:
C1.00

WATERLINE '1'

⑩ STA. 10+00.00
CONST. (1) 8" X 6" CUT IN TEE W/
MECHANICAL JOINTS
FL = 1241.37

⑪ STA. 10+03.00
CONST. (1) 6" GATE VALVE & BOX
FL = 1241.37

⑫ STA. 10+06.00
CONST. (1) FIRE HYDRANT
CONST. (1) FIRE HYDRANT RISER (IF
NEEDED)
FL=1241.37

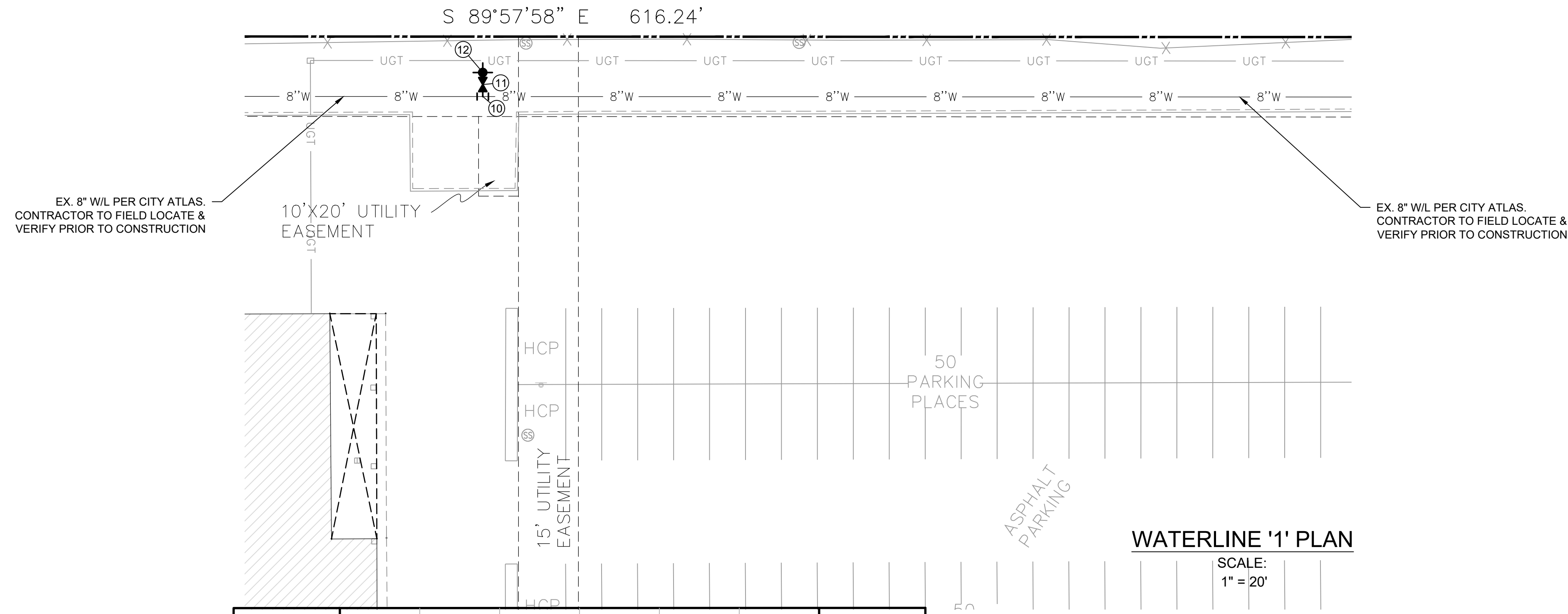

EX. 8" W/L PER CITY ATLAS.
CONTRACTOR TO FIELD LOCATE &
VERIFY PRIOR TO CONSTRUCTION

EX. 8" W/L PER CITY ATLAS.
CONTRACTOR TO FIELD LOCATE &
VERIFY PRIOR TO CONSTRUCTION

- NOTES:
- WHERE FILL MATERIAL IS INDICATED SUCH MATERIAL SHALL BE PLACED AND COMPACTED IN SIX (6) INCH LIFTS FOR HAND-TAMPED EQUIPMENT AND THIRTY (30) INCH LIFTS FOR POWER-DRIVEN EQUIPMENT TO 95% STANDARD PROCTOR DENSITY PRIOR TO TRENCHING.
 - CONTRACTOR SHALL FIELD LOCATE AND VERIFY UTILITY CROSSINGS PRIOR TO CONSTRUCTION.

WATERLINE '1' PLAN

SCALE:
1" = 20'

WATERLINE '1' PROFILE		
CONST. (1) 6 L.F. OF 6" W/L (C-900)		
SCALE:		
HORIZ: 1" = 10'		
VERT: 1" = 1'		
1249		1249
1248		1248
1247		1247
1246	EX. CL OF CONSTRUCTION	1246
1245		1245
1244		1244
1243	EX. 8" W/L	1243
1242	18.21 L.F. OF EX. 6" W/L TO BE REMOVED	1242
1241		1241
1240		1240
1239		1239
1238		1238

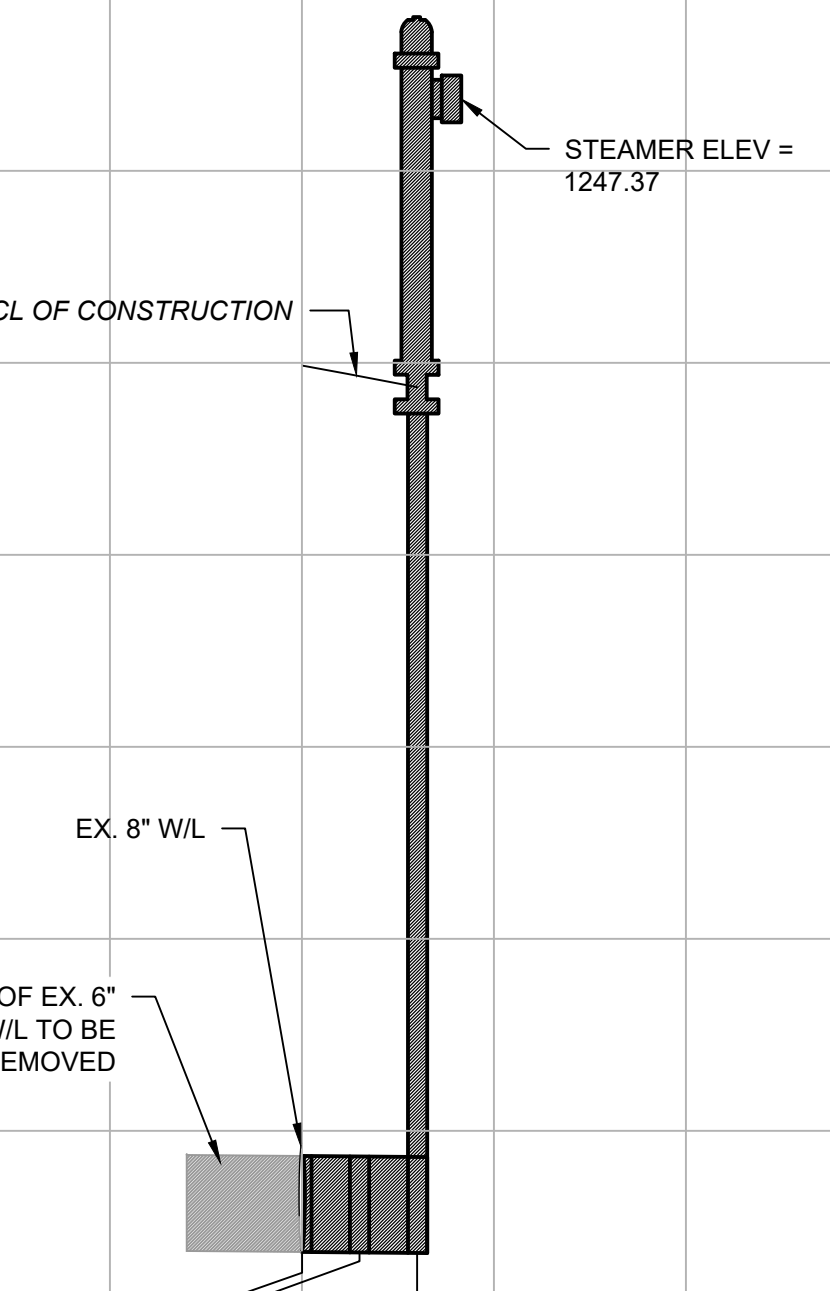

⑩ STA. 10+00.00
CONST. (1) 8" X 6" CUT IN TEE
W/MECHANICAL JOINTS
FL = 1241.37

⑪ STA. 10+03.00
CONST. (1) 6" GATE VALVE & BOX
FL = 1241.37

⑫ STA. 10+06.00
CONST. (1) FIRE HYDRANT
CONST. (1) FIRE HYDRANT RISER (IF
NEEDED)
FL=1241.37

WATER NOTES

- ALL CONSTRUCTION TO BE IN ACCORDANCE WITH CITY OF MOORE STANDARD SPECIFICATIONS FOR PUBLIC IMPROVEMENTS.
- ALL FIRE HYDRANTS & VALVE BOXES TO BE SET TO PROPOSED FINAL GRADE WITH 4 1/2" STEAMER NOZZLE A MINIMUM AT 18" & A MAXIMUM OF 24" ABOVE GROUND LEVEL. ALL FIRE HYDRANTS TO HAVE DUCTILE IRON LEADS.
- ALL EXISTING WATER MAINS BEING ABANDONED BY THIS PROJECT ARE TO REMAIN THE PROPERTY OF THE CITY OF MOORE AND SHALL BE SALVAGED BY THE WATER/WASTEWATER DEPARTMENT AT THEIR DISCRETION. HOWEVER, ITEMS IN THE WAY OF CONSTRUCTION MAY BE REMOVED AND DELIVERED TO THE WATER DEPARTMENT WAREHOUSE.
- IN CASES WHERE MINIMUM HORIZONTAL AND VERTICAL SEPARATION FROM ADJACENT SANITARY SEWER LINES (SEE OAC 252.626-19) CANNOT BE MAINTAINED, CONTRACTOR SHALL ENCLOSE WATER MAIN IN APPROPRIATELY SIZED STEEL CASING. CASING SHALL EXTEND A MINIMUM OF 10-FT IN EITHER DIRECTION FROM WHERE HORIZONTAL OR VERTICAL SEPARATION IS LESS THAN MINIMUM ALLOWED BY OKLAHOMA DEPARTMENT OF ENVIRONMENTAL QUALITY (ODEQ) REGULATIONS.
- WHEN CROSSING STREETS, DRIVEWAYS SUBJECT TO HEAVY TRAFFIC, ALLEYS AND STRUCTURES, ETC., PIPE SHALL BE INSTALLED WITH COMPACTED ODOT TYPE 'A' BACKFILL. ALL OTHER PIPE TO BE INSTALLED IN ACCORDANCE WITH MANUFACTURERS RECOMMENDATIONS OR CITY SPECIFICATION.
- SET END OF MAIN STUBS IN CUL-DE-SACS AT A POINT 5.0' OFF PROPERTY LINE. THIS POINT BEING IN LINE WITH SIDE PROPERTY LINE.
- IN INSTANCES WHERE FLOW LINES ARE NOT INDICATED ON THE DRAWINGS, MAIN SHALL BE CONSTRUCTED WITH A MINIMUM OF 4' COVER OR AS DIRECTED BY THE CITY'S DESIGNATED REPRESENTATIVE.
- ALL STAKING FOR ALIGNMENT AND GRADE WILL BE DONE UNDER THE SUPERVISION OF LAND SURVEYOR REGISTERED IN THE STATE OF OKLAHOMA. GRADE STAKES WILL BE MARKED AND CUT SHEETS WILL BE FURNISHED TO THE CITY'S DESIGNATED REPRESENTATIVE ON THE PROJECT PRIOR TO CONSTRUCTION.
- UNLESS SPECIFICALLY AUTHORIZED, ALL GATE VALVES ARE TO BE LOCATED AT P.C. OR P.T. OF STREET CURB. WHEN FIRE HYDRANTS ARE REQUIRED THEY SHALL BE LOCATED WITHIN 5' OF GATE VALVES.
- POLY WRAP ALL CAST OR DUCTILE STEEL FITTINGS PRIOR TO BACKFILLING.



GENERAL NOTES

DETAIL NO.
300
APPROVED
09/18/2023

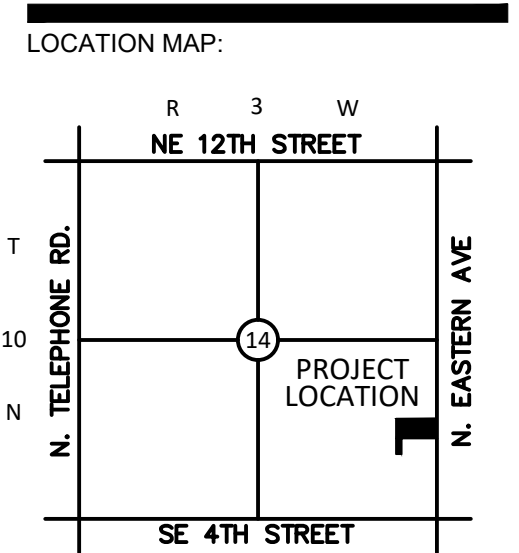
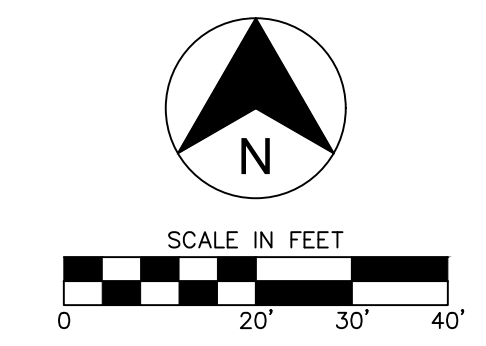

NOT TO SCALE

PROJECT:

MPS DAYCARE

201 N. EASTERN
MOORE OK

PROJECT NUMBER: 24110
DRAWING DATE: 11.05.24
ISSUE DATE: 11.05.24

SEAL:



SUBMITTAL:
PERMIT SET

REVISIONS:

MARK DATE DESCRIPTION

THESE PLANS AND DRAWINGS ARE NOT TO BE REPRODUCED, CHANGED OR COPIED IN ANY FORM OR MANNER WHATSOEVER WITHOUT FIRST OBTAINING THE WRITTEN PERMISSION AND CONSENT OF CEDAR CREEK CONSULTING INC. THIS SHEET IS NOT TO BE USED FOR CONSTRUCTION UNLESS THE ISSUE DATE IN THE TITLE BLOCK COINCIDES WITH OR POST DATES THE DRAWING DATE. ANY CHANGES MADE FROM THESE PLANS WITHOUT CONSENT OF CEDAR CREEK CONSULTING INC. ARE UNAUTHORIZED AND SHALL RELIEVE CEDAR CREEK CONSULTING OF RESPONSIBILITY FOR ALL CONSEQUENCES ARISING OUT OF SUCH CHANGES.

DRAWING TITLE:

**WATERLINE '1'
PLAN &
PROFILE**

SHEET:

C2.00

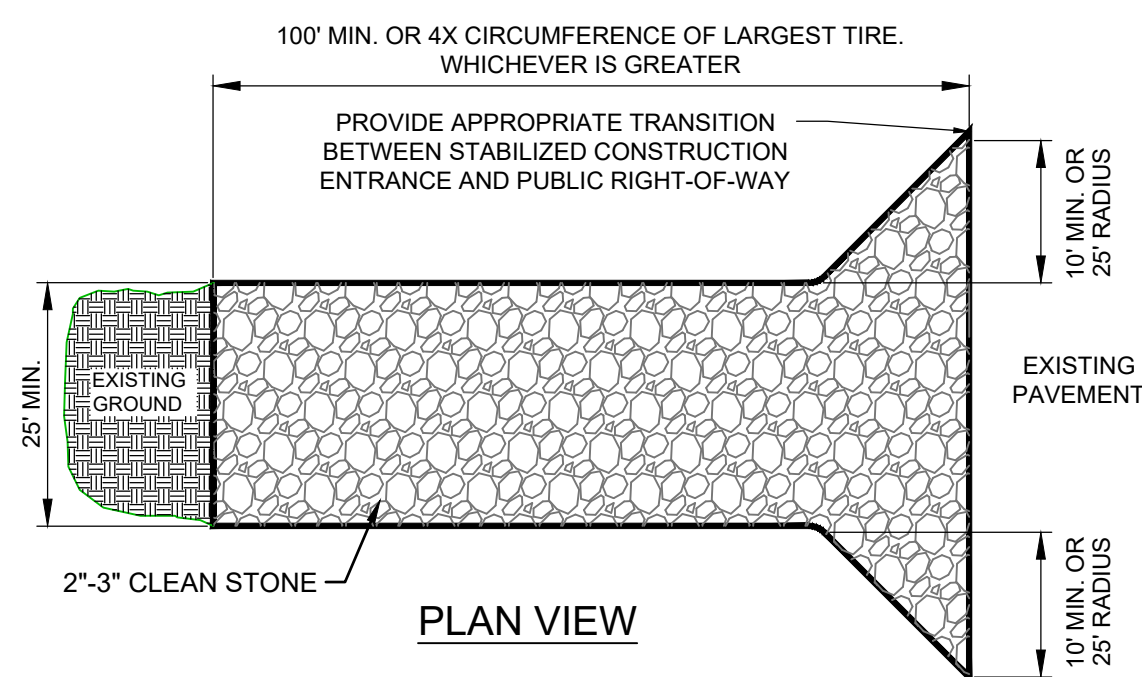
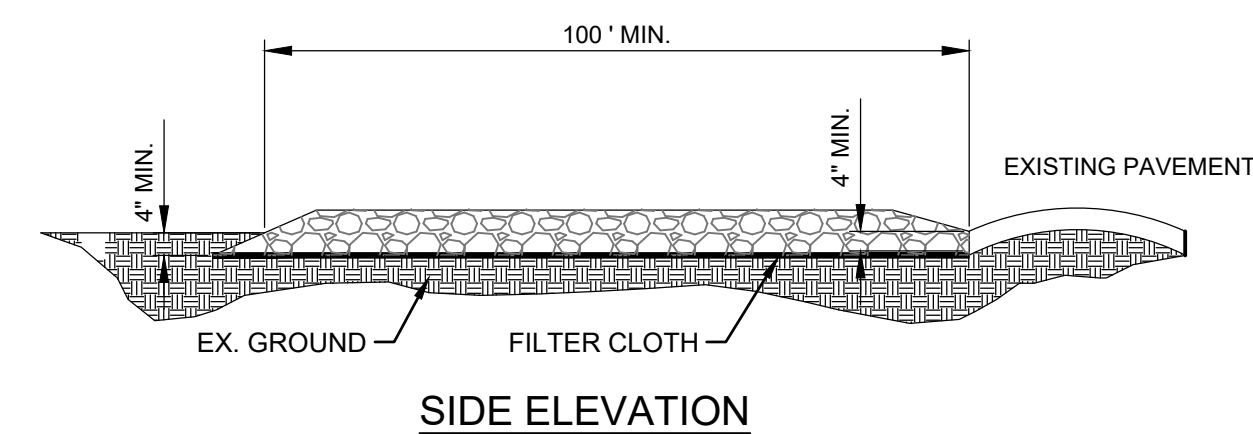

- NOTES:
1. STONE - USE COARSE AGGREGATE (2 - 3 INCH STONE)
 2. LENGTH - AS EFFECTIVE, BUT NOT LESS THAN 100 FEET.
 3. THICKNESS - NOT LESS THAN EIGHT (8) INCHES.
 4. WIDTH - NOT LESS THAN FULL WIDTH OF ALL POINTS OF INGRESS OR EGRESS.
 5. WASHING - WHEN NECESSARY, WHEELS SHALL BE CLEANED TO REMOVE SEDIMENT PRIOR TO ENTRANCE ONTO PUBLIC RIGHT-OF-WAY. WHEN WASHING IS REQUIRED, IT SHALL BE DONE ON AN AREA STABILIZED WITH CRUSHED STONE WHICH DRAINS INTO AN APPROVED SEDIMENT TRAP OR SEDIMENT BASIN. ALL SEDIMENT SHALL BE PREVENTED FROM ENTERING ANY STORM DRAIN, DITCH, OR WATERCOURSE THROUGH USE OF SAND BAGS, GRAVEL, BOARDS OR OTHER APPROVED METHODS.
 6. MAINTENANCE - THE ENTRANCE SHALL BE MAINTAINED IN A CONDITION WHICH WILL PREVENT TRACKING OR FLOWING OF SEDIMENT ONTO PUBLIC RIGHT-OF-WAY. THIS MAY REQUIRE PERIODIC TOP DRESSING WITH ADDITIONAL STONE AS CONDITIONS DEMAND AND REPAIR AND/OR CLEANOUT OF ANY MEASURES USED TO TRAP SEDIMENT. ALL SEDIMENT SPILLED, DROPPED, WASHED OR TRACKED ONTO PUBLIC RIGHTS-OF-WAY MUST BE REMOVED IMMEDIATELY.
 7. 12" X 24" METAL GRATE MAY BE USED. GRATE SHALL BE 25' AWAY FROM PAVEMENT AND APPROPRIATE SEDIMENT CONTROL TRAPPING DEVICE SHALL BE USED AT GRATE OUTLET POINT.

STABILIZED CONSTRUCTION ENTRANCE

NOT TO SCALE

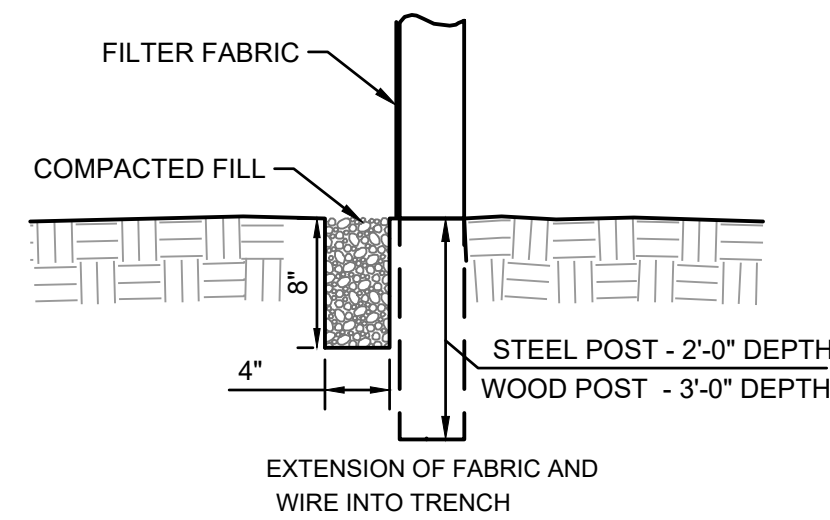
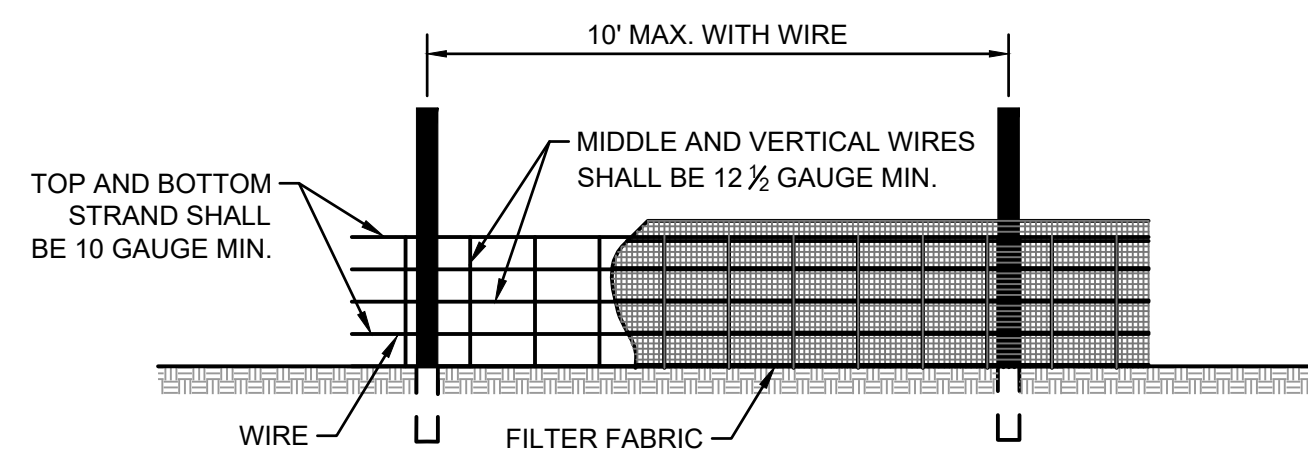

- NOTES:
1. WIRE SHALL BE A MINIMUM OF 32" IN WIDTH AND SHALL HAVE A MINIMUM OF 6 LINE WIRES WITH 12" STAY SPACING.
 2. FILTER FABRIC SHALL BE A MINIMUM OF 36" IN WIDTH AND SHALL BE FASTENED ADEQUATELY TO THE WIRE.
 3. STEEL POST SHALL BE 5'-0" IN HEIGHT AND BE OF THE SELF-FASTENER ANGLE STEEL TYPE.
 4. WOOD POST SHALL BE 6'-0" IN HEIGHT AND 3" IN DIAMETER.

SILT FENCE DETAIL

NOT TO SCALE

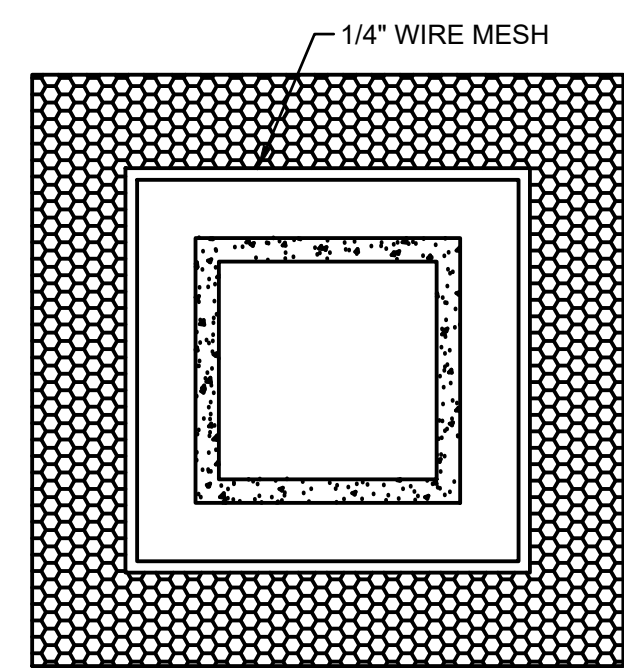
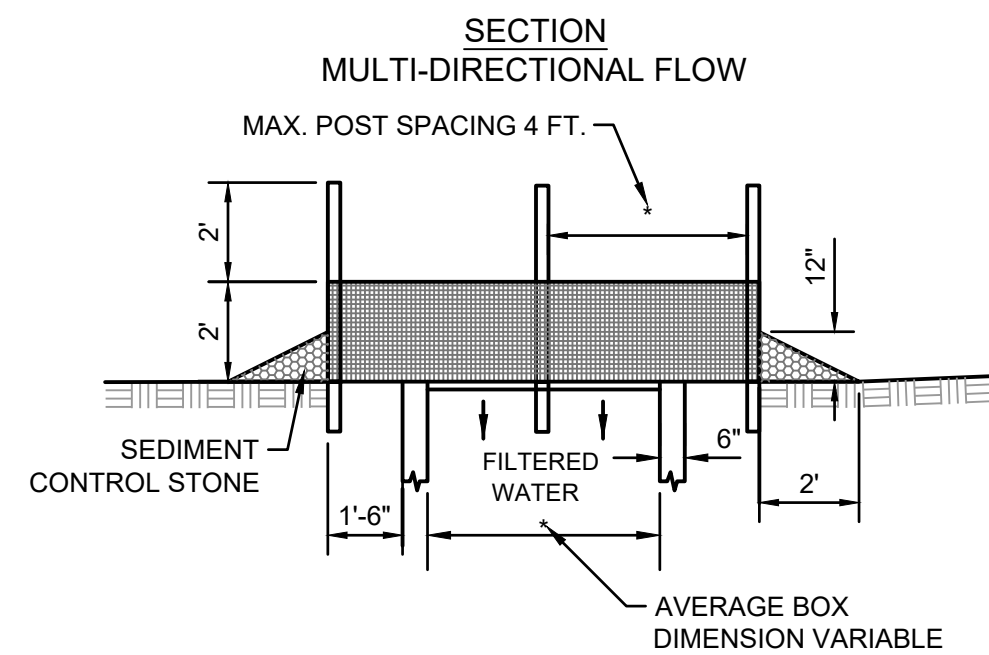

- NOTES:
1. SEDIMENT CONTROL STONE SHALL BE 3/4" WASHED STONE.
 2. WIRE MESH SHALL BE HARDWARE CLOTH 23 GAUGE MIN. AND SHALL HAVE 1/4" MESH OPENINGS.
 3. TOP OF WIRE MESH SHALL BE A MINIMUM OF ONE FOOT BELOW THE SHOULDER OR ANY DIVERSION POINT.
 4. STEEL POST SHALL BE 5 FT. IN HEIGHT, BE INSTALLED 1.5 FT. DEEP MINIMUM, AND BE OF THE SELF-FASTENER ANGLE STEEL TYPE.
 5. WOOD POST SHALL BE 6 FT. IN HEIGHT, BE INSTALLED TO 1.5 FT. DEEP MINIMUM, AND BE 3 INCHES IN DIAMETER.
 6. POST SPACING SHALL BE A MAXIMUM OF 4 FT.

INLET PROTECTION DETAIL

NOT TO SCALE

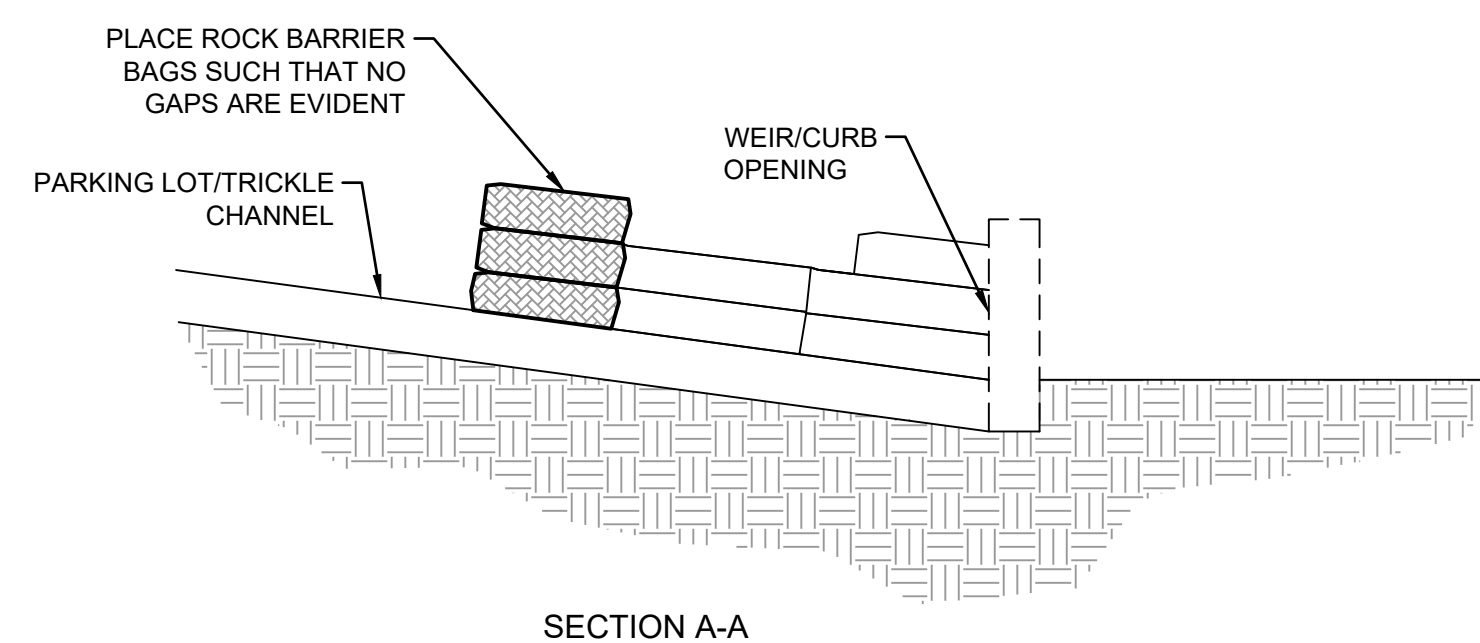
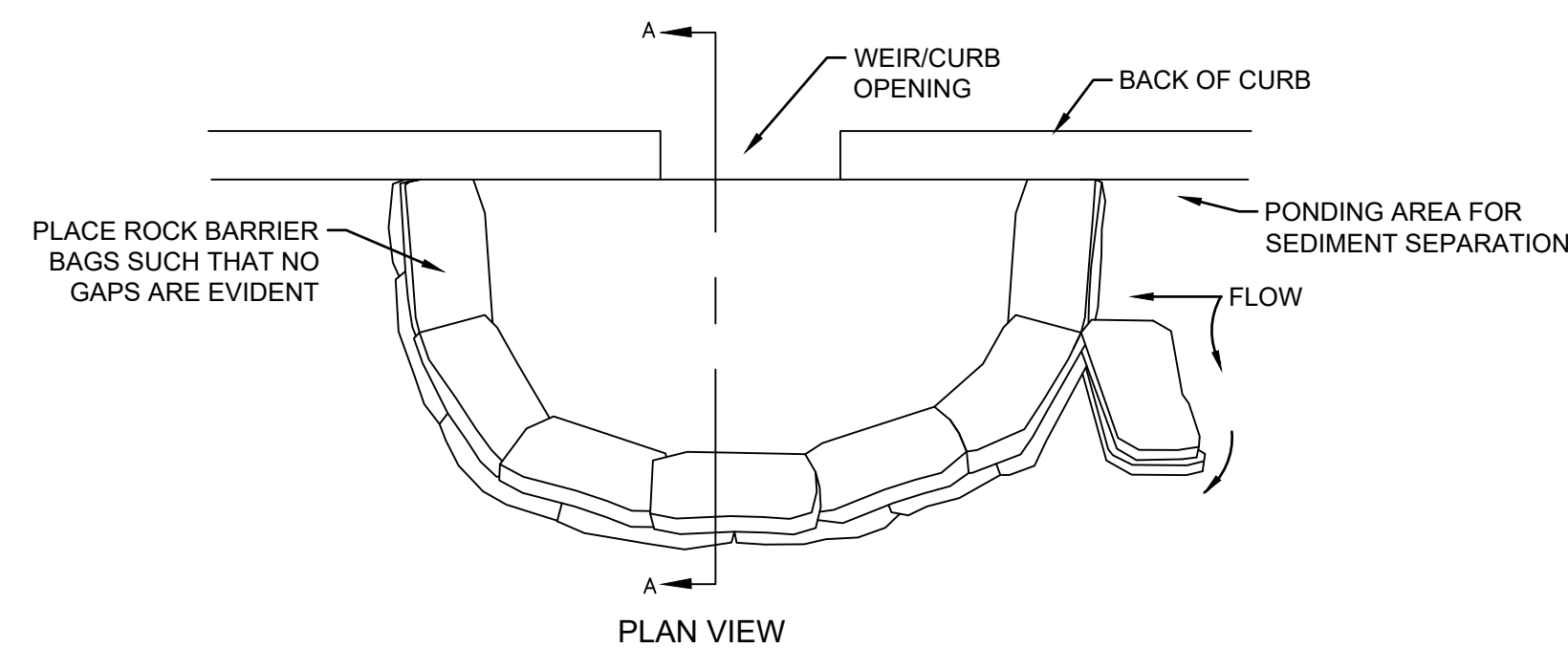

CURB INLET PROTECTION DETAIL

NOT TO SCALE

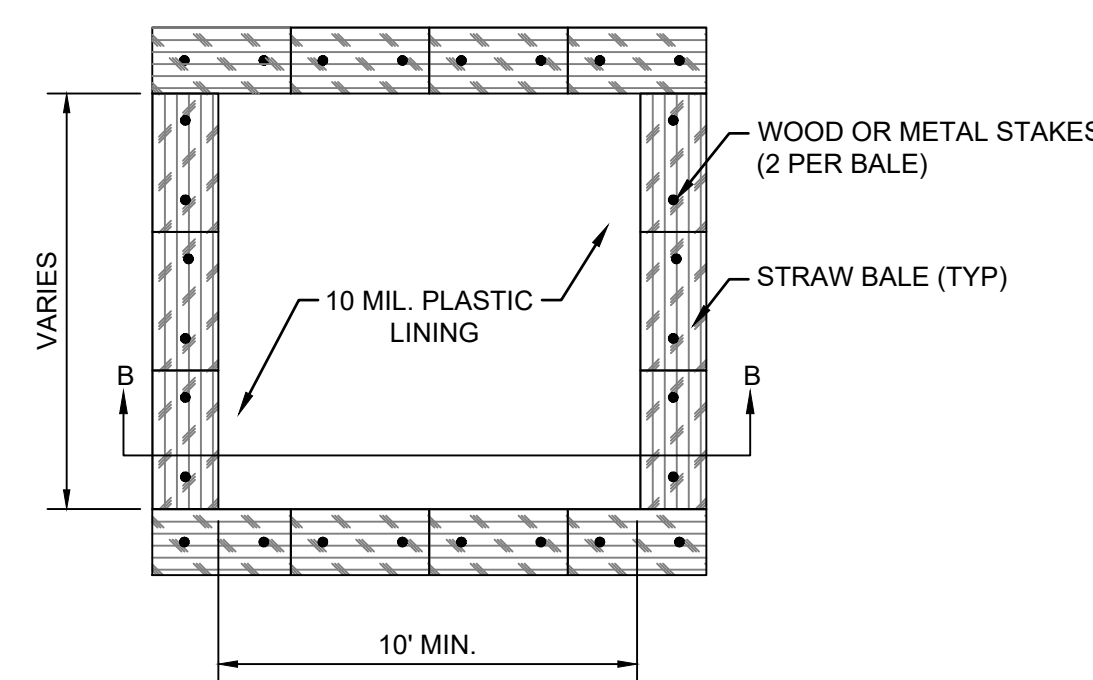
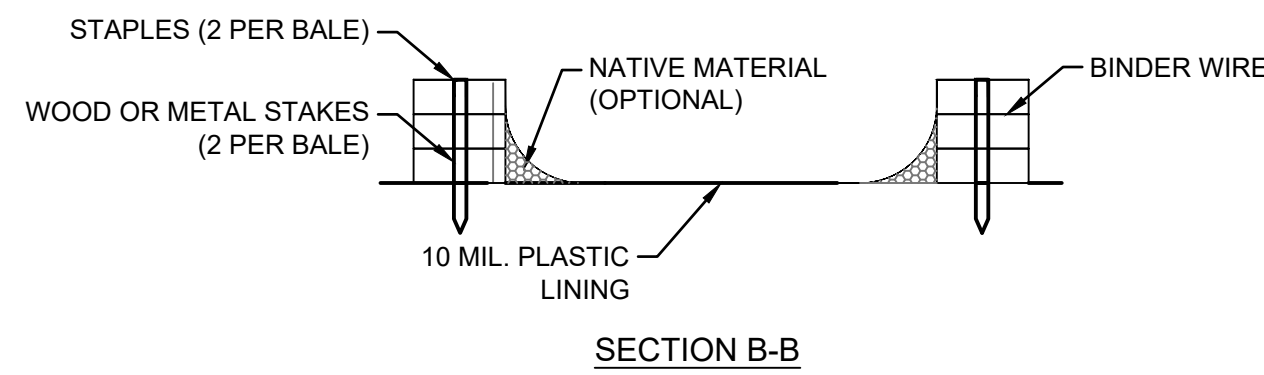

TYPE 'ABOVE GRADE' WITH STRAW BALES

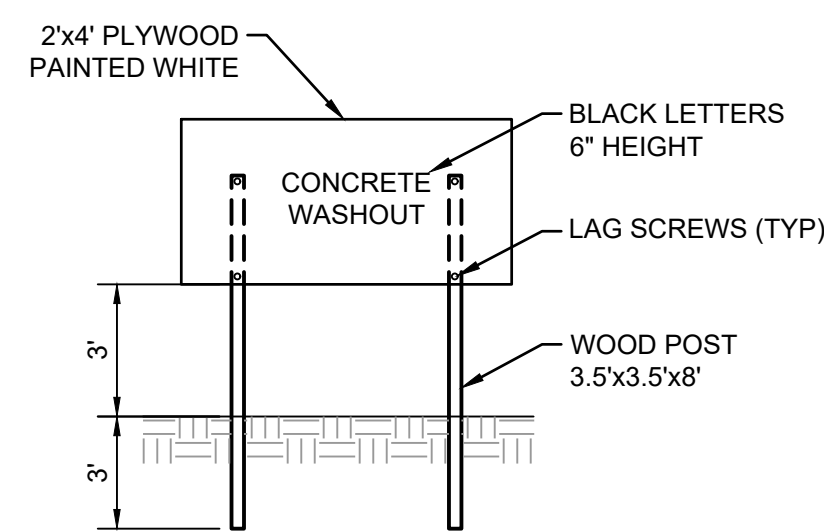

CONCRETE WASHOUT SIGN DETAIL

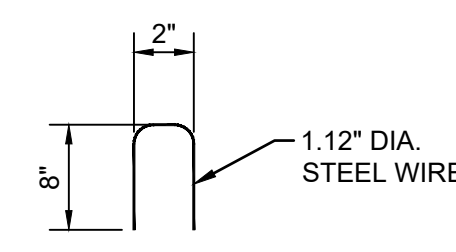

STAPLE DETAIL

- NOTES:
1. ACTUAL LAYOUT TO BE DETERMINED IN THE FIELD.
 2. A CONCRETE WASHOUT SIGN SHALL BE INSTALLED WITHIN 30' OF THE TEMPORARY CONCRETE WASHOUT FACILITY.
 3. MATERIALS USED TO CONSTRUCT TEMPORARY CONCRETE WASHOUT FACILITIES SHALL BE REMOVED FROM THE SITE OF THE WORK AND DISPOSED OF OR RECYCLED.
 4. HOLES, DEPRESSIONS OR OTHER GROUND DISTURBANCE CAUSED BY THE REMOVAL OF THE TEMPORARY CONCRETE WASHOUT FACILITIES SHALL BE BACKFILLED, REPAIRED AND STABILIZED TO PREVENT EROSION.

CONCRETE WASHOUT DETAIL

NOT TO SCALE

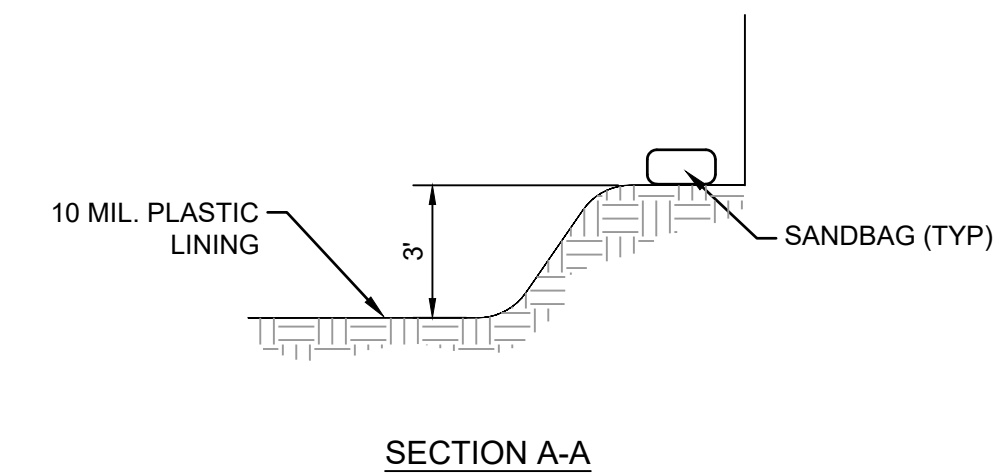

SECTION A-A

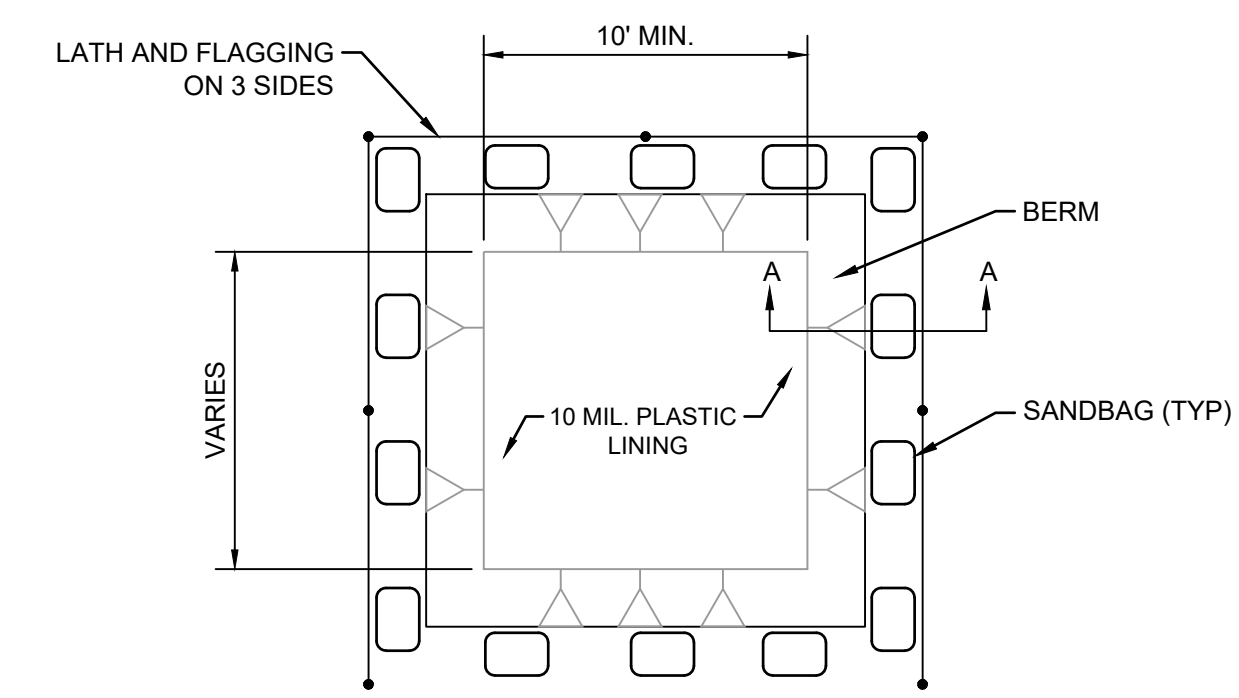

TYPE 'BELOW GRADE'

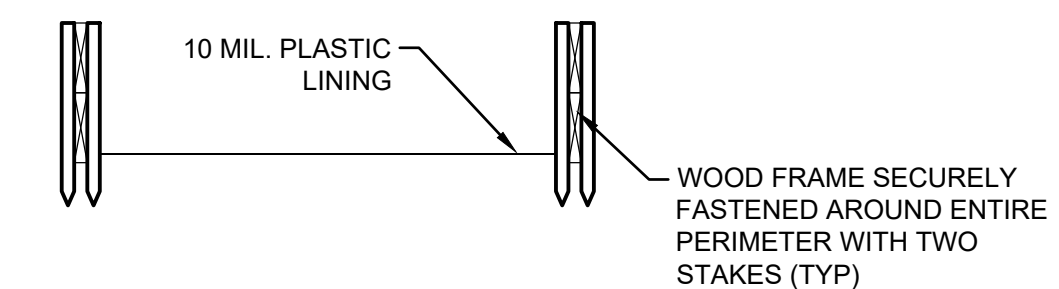

SECTION C-C

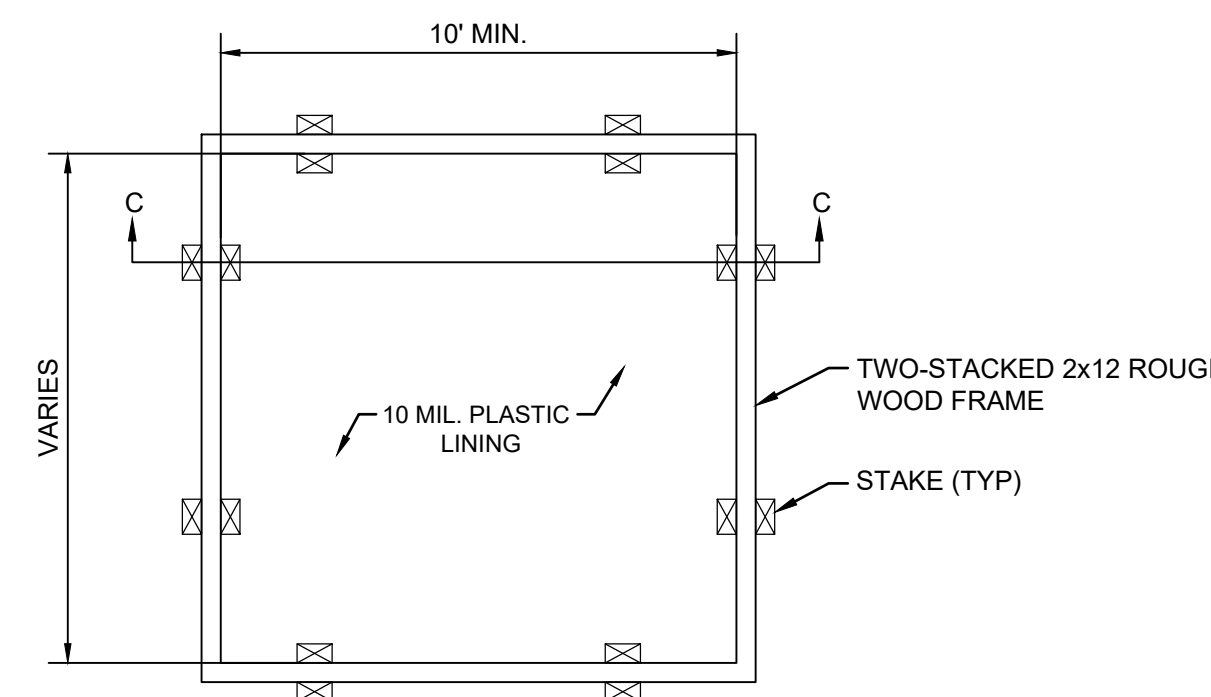

TYPE 'ABOVE GRADE' WITH WOOD PLANKS

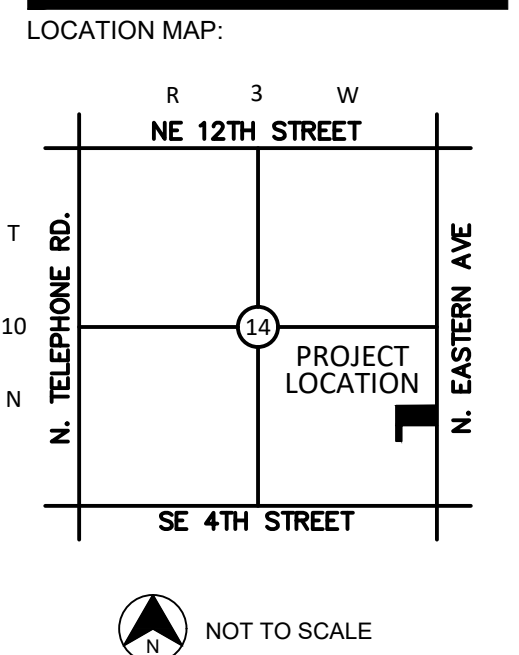

PROJECT:

MPS DAYCARE

201 N. EASTERN
MOORE OK

PROJECT NUMBER: 24110
 DRAWING DATE: 11.05.24
 ISSUE DATE: 11.05.24

SEAL:



SUBMITTAL:

PERMIT SET

REVISIONS:

NO.	DATE	DESCRIPTION

MARK DATE DESCRIPTION

THESE PLANS AND DRAWINGS ARE NOT TO BE REPRODUCED, CHANGED OR COPIED IN ANY FORM OR MANNER WHATSOEVER WITHOUT FIRST OBTAINING THE WRITTEN PERMISSION AND CONSENT OF CEDAR CREEK CONSULTING INC. THIS SHEET IS NOT TO BE USED FOR CONSTRUCTION UNLESS THE ISSUE DATE IN THE TITLE BLOCK COINCIDES WITH OR POST DATES THE DRAWING DATE. ANY CHANGES MADE FROM THESE PLANS WITHOUT CONSENT OF CEDAR CREEK CONSULTING INC. ARE UNAUTHORIZED AND SHALL RELIEVE CEDAR CREEK CONSULTING OF RESPONSIBILITY FOR ALL CONSEQUENCES ARISING OUT OF SUCH CHANGES.

DRAWING TITLE:

EROSION CONTROL DETAILS

SHEET:

C3.01